



PERFECT

PERFECT TECHNOLOGY CO.,LTD

2017



www.perfect-cnc.com

Tungsten steel Aseismic Shank

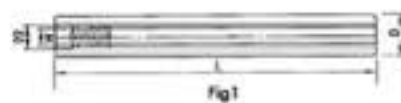

1. Use advanced material made of tungsten carbide. Excellent rigidity, good shock absorption
2. extend the depth of processing, improve the accuracy of the machined surface, Achieve long ultra deep, ultra-precision machining of Feasibility
3. Reduce tool costs, longer tool life

Order no	D	L	M	d2
GL08-08-100-M04	8	100	M4*0.7	4.5
GL08-08-120-M04	8	120	M4*0.7	4.5

Order no	D	L	M	d2
GL10-10-100-M05	10	100	M5*0.8	5.5
GL10-10-150-M05	10	150	M5*0.8	5.5

Order no	D	L	M	d2
GL12-12-100-M06	12	100	M6*1.0	6.5
GL12-12-150-M06	12	150	M6*1.0	6.5
GL12-12-200-M06	12	200	M6*1.0	6.5

Order no	D	L	M	d2
GL16-16-100-M08	16	100	M8*1.25	8.5
GL16-16-150-M08	16	150	M8*1.25	8.5
GL16-16-200-M08	16	200	M8*1.25	8.5
GL16-16-250-M08	16	250	M8*1.25	8.5

Order no	D	L	M	d2
GL20-20-100-M10	20	100	M10*1.5	10.5
GL20-20-150-M10	20	150	M10*1.5	10.5
GL20-20-200-M10	20	200	M10*1.5	10.5
GL20-20-250-M10	20	250	M10*1.5	10.5
GL20-20-300-M10	20	300	M10*1.5	10.5

Order no	D	L	M	d2
GL25-25-100-M12	25	100	M12*1.75	12.5
GL25-25-150-M12	25	150	M12*1.75	12.5
GL25-25-200-M12	25	200	M12*1.75	12.5
GL25-25-250-M12	25	250	M12*1.75	12.5
GL25-25-300-M12	25	300	M12*1.75	12.5
GL25-25-350-M12	25	350	M12*1.75	12.5

Order no	D	L	M	d2
GL32-32-150-M16	32	150	M16*2.0	17
GL32-32-200-M16	32	200	M16*2.0	17
GL32-32-250-M16	32	250	M16*2.0	17
GL32-32-300-M16	32	300	M16*2.0	17
GL32-32-350-M16	32	350	M16*2.0	17
GL32-32-400-M16	32	400	M16*2.0	17

After pulling Arbor tungsten steel

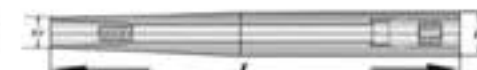
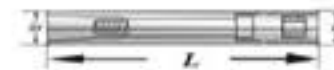

Order no	L	L1	D	D1
DC4-08-C08-100L	100		8	8
DC4-10-C10-100L	100		10	10
DC4-10-C10-150L	150		10	10
DC4-10-C12-150L-DT60	150	60	12	10
DC4-10-C16-200L-DT100	200	100	16	10

Order no	L	L1	D	D1
DC6-12-C12-100L	100		12	12
DC6-12-C12-150L	150		12	12
DC6-12.8-C16-150L-DT60	150	60	16	12.8
DC6-12.8-C16-200L-DT90	200	90	16	12.8
DC6-12.8-C20-250L-DT110	250	110	20	12.8

Order no	L	L1	D	D1
UC10-20-C20-150L	150		20	20
UC10-20-C20-200L	200		20	20
UC10-23-C25-250L-DT120	250	120	25	23
UC10-23-C25-300L-DT120	300	120	25	23

- After pulling Arbor tungsten steel Features:
1. Use the advanced tungsten carbide materials. Quality made excellent rigidity, suck Good shock resistance
 2. extend the depth of processing, improve Machined surface precision, ultra Long ultra deep, ultra-high precision plus The feasibility work
 3. Reduce tool costs and extend Tool life



Order no	d	L	D	Weight kg	Hex Wrench
SDC4	3 3.5 4 4.5	31	7	0.01	M3
SDC6	1/8 3 3.5 4 4.5 5 5.5 6	36	9.8	0.01	M4
Order no	d	L	L1	Weight kg	Hex Wrench
SDC10	3 4 6 8 10	56.5	15	0.07	M5

新型 EX 高速防震鎢鋼銑刀

防震鎢鋼銑刀加工數據

EX 材質:德國 鈷鎢 K44 HRC: 25° ~ 52°
 4EA 材質:(0.5u Co12%) HRC: 25° ~ 52°

防震銑刀 45 4刃 R溝
 (不等份螺旋+不等分割) 3倍長

特點: 外周刃不等距導程=刀刃角度不同鐵削易脫落
 底刃不等距分割=抗震,壽命更長



外周刃不等距導程



底刃不等距分割

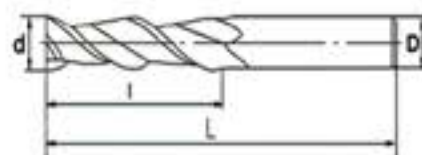

EX 產品編號	4EA 產品編號	刃徑 / d	刃長 / l	全長 / L	柄徑 / D
EX 0200504	4EA 0200504	2	6	50	4
EX 0300504	4EA 0300504	3	9	50	4
EX 0400504	4EA 0400504	4	12	50	4
EX 0500506	4EA 0500506	5	15	50	6
EX 0600506	4EA 0600506	6	18	50	6
EX 0800608	4EA 0800608	8	24	60	8
EX 1007510	4EA 1007510	10	30	75	10
EX 1210012	4EA 1210012	12	30	75	12

Processed data

EX銑刀	刃數	進刀量	轉速S	進刀F
3mm	4	0.03	12739	1529
3mm	4	0.04		2038
3mm	4	0.05		2548
4mm	4	0.03	9554	1146
4mm	4	0.04		1529
4mm	4	0.05		1911
6mm	4	0.03	6369	764
6mm	4	0.04		1019
6mm	4	0.05		1274
8mm	4	0.03	4777	573
8mm	4	0.04		764
8mm	4	0.05		955
10mm	4	0.03	3822	459
10mm	4	0.04		611
10mm	4	0.05		764
12mm	4	0.03	3185	382
12mm	4	0.04		510
12mm	4	0.05		637

45° Tungsten steel 4 - blade cutter

4JE 45°



HRC52 following
0.5u, Co12%
Plated ALTiN

2JE 45°



HRC45 following
0.6u, Co12%
Plated TS

5JE 45°



HRC55 following
0.3u, Co12%
Plated TS

Other longer type, please call us

產品編號	刃徑 d	刃長 l	全長 L	柄徑 D
JE-0100504	1	3	50	4 / 6
JE-0150504	1.5	4	50	4 / 6
JE-0200504	2	6	50	4 / 6
JE-0250504	2.5	7	50	4 / 6
JE-0300503	3	8	50	3 / 4 / 6
JE-0350504	3.5	10	50	4 / 6
JE-0400504	4	11	50	4 / 6
JE-0550506	5	13	50	6
JE-0600608	6	15	60	6
JE-0800608	8	20	60	8
JE-1007510	10	25	75	10
JE-1210012	12	30	75	12
JE-1410016	14	40	100	16
JE-1610012	16	45	100	16
JE-1810018	18	45	100	20
JE-2010020	20	45	100	20

Tungsten steel R angle

4AR Tungsten steel R angle



HRC52 following
0.5u, Co12%
Plated ALTiN

ALR Tungsten steel for aluminum



HRC45 following
0.6u, Co12%
Plated TS

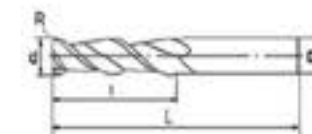

Other longer type, please call us

產品編號	柄徑 d	R角	刃長 l	全長 L	柄徑 D
4AR-01002	1	R0.2	2	50	4 / 6
4AR-01502	1.5	R0.2	3	50	4 / 6
4AR-01505	1.5	R0.5	3	50	4 / 6
4AR-02002	2	R0.2	4	50	4 / 6
4AR-02005	2	R0.5	4	50	4 / 6
4AR-02502	2.5	R0.2	5	50	4 / 6
4AR-02505	2.5	R0.5	5	50	4 / 6
4AR-03002	3	R0.2	6	50	3 / 4 / 6
4AR-03005	3	R0.5	6	50	3 / 4 / 6
4AR-03010	3	R1	6	50	3 / 4 / 6
4AR-04002	4	R0.2	8	50	4 / 6
4AR-04005	4	R0.5	8	50	4 / 6
4AR-04010	4	R1	8	50	4 / 6
4AR-05005	5	R0.5	10	50	6
4AR-05010	5	R1	10	50	6
4AR-06002	6	R0.2	12	50	6
4AR-06005	6	R0.5	12	50	6
4AR-06010	6	R0.1	12	50	6
4AR-06015	6	R1.5	12	50	6
4AR-08002	8	R0.2	16	60	8
4AR-08005	8	R0.5	16	60	8
4AR-08010	8	R1	16	60	8
4AR-08020	8	R2	16	60	8
4AR-10005	10	R0.5	20	75	10
4AR-10010	10	R1	20	75	10
4AR-10020	10	R2	20	75	10
4AR-12005	12	R0.5	24	75	12
4AR-12010	12	R1	24	75	12
4AR-12020	12	R2	24	75	12
4AR-12030	12	R3	24	75	12

Tungsten steel roughing cutter

4JH Tungsten steel roughing cutter



HRC52 following
0.5u, Co12%
Plated ALTiN



產品編號	刃徑 / d	刃長 / H	全長 / L	柄徑 / D
JH-0406050	4	11	50	6
JH-0606050	6	15	50	6
JH-0808060	8	20	60	8
JH-1010075	10	25	75	10
JH-1212100	12	30	100	12

AJH Tungsten steel for aluminum



HRC45 following
0.6u, Co12%
Plated TS

NC Tungsten steel drill point



4NC General steel used



2NC Tungsten steel for aluminum

產品編號	刃徑 d	角度 a	柄徑 D	全長 L
4NC39050	3	90° / 120°	3	50
4NC49050	4	90° / 120°	4	50
4NC59050	5	90° / 120°	5	50
4NC69050	6	90° / 120°	6	50
4NC89060	8	90° / 120°	8	60
4NC109075	10	90° / 120°	10	75
4NC129075	12	90° / 120°	12	75

Tungsten steel aluminum dedicated



ALM 50°
ALN 45°



ALB 55°

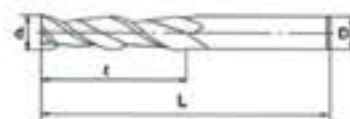

HRC45 following
Material: 0.6u Co12%

Another long-edge long-type,
please contact us

產品編號	刃徑d	刃長l	全長L	柄徑D
ALM-0104050	1	3	50	4/6
ALM-0154050	1.5	5	50	4/6
ALM-0204050	2	6	50	4/6
ALM-0254050	2.5	8	50	4/6
ALM-0304050	3	9	50	3/4/6
ALM-0404050	4	12	50	4/6
ALM-0506050	5	13	50	6
ALM-0606050	6	18	50	6
ALM-0708060	7	21	60	8
ALM-0808060	8	24	60	8
ALM-0910075	9	27	75	10
ALM-1010075	10	30	75	10
ALM-1112075	11	33	75	12
ALM-1212075	12	36	75	12
ALM-1414075	14	45	100	14
ALM-1616100	16	50	100	16
ALM-2020100	20	50	100	20

3 5° Tungsten steel 2 - blade cutter

4JF 35° HRC52 following
0.5u, Co12%
Plated ALTiN



2JF 35 HRC45 following
0.6u, Co12%
Plated TS

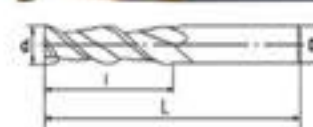

產品編號	刃徑 / d	刃長 / l	全長 / L	柄徑 / D
JF-0100504	1	3	50	4/6
JF-0200504	2	6	50	4/6
JF-0300504	3	8	50	3/4/6
JF-0400504	4	11	50	4/6
JF-0600506	6	15	50	6
JF-0800608	8	20	60	8
JF-1007510	10	25	75	10
JF-1210012	12	30	75	12
JF-1610012	16	45	100	16
JF-1810018	18	45	100	20
JF-2010020	20	45	100	20

Tungsten steel ball cutter 2 blade



ALA 30° HRC45 following
0.6u, Co12%



4BA 30° HRC52 following
0.5u, Co12%
Plated ALTiN



2BA 30° HRC45 following
0.6u, Co12%
Plated TS



5BA 30° HRC55 following
0.3u, Co12%
Plated TX



小徑球刀

產品編號	球頭半徑R	刃徑d	刃長l	全長L	柄徑D
BA-0300	1.5R	3	6	50	3/4/6
BA-0350	1.75R	3.5	7	50	4/6
BA-0400	2R	4	8	50	4/6
BA-0100	0.5R	1	2	50	4/6
BA-0150	0.75	1.5	3	50	4/6
BA-0200	1R	2	4	50	4/6
BA-0250	1.25R	2.5	5	50	4/6
BA-0450	2.25R	4.5	9	50	6
BA-0500	2.5R	5	10	50	6
BA-0600	3R	6	12	50	6
BA-0700	3.5R	7	14	60	8
BA-0800	4R	8	16	60	8
BA-0900	4.5R	9	18	75	10
BA-1000	5R	10	20	75	10
BA-1100	5.5R	11	22	75	12
BA-1200	6R	12	24	75	12
BA-1400	7R	14	28	75	16
BA-1600	8R	16	32	100	16
BA-2000	10R	20	40	100	20

4TB 240° Tungsten steel ball-cutter

Lollipop ball knife

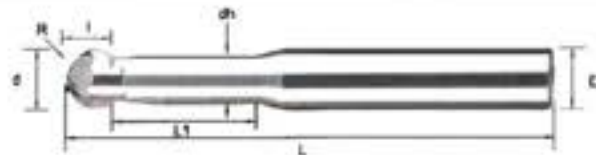

HRC55 following
Material: 0.5u Co12%

產品編號	球頭半徑/R	外徑 d	刃長 l	頸徑 dh	頸長 L1	刃數	柄徑 D	全長L
4TB020450	1R	2	1.63	1.53	3	2	4	50
4TB030450	1.5R	3	2.46	2.3	3	2	4	50
4TB040450	2R	4	3.3	3.06	5	2	4	50
4TB050650	2.5R	5	4.1	3.83	5	2	6	50
4TB060650	3R	6	4.93	4.6	5	2	6	50
4TB080660	4R	8	6.58	6.15	6	2	8	75
4TB101075	5R	10	8.22	7.66	8	2	10	75
4TB121275	6R	12	9.86	9.2	10	2	12	75

Tungsten steel chamfering knife up and down

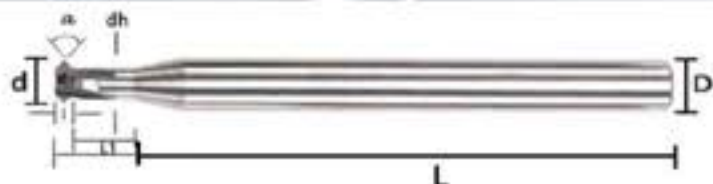

HRC52 following
0.5u, Co12%

產品編號	刃徑 d	角度 α	刃長 l	頸徑 dh	頸長 L1	刃數	柄徑 D	全長 L
GV2R2040490	4	90	1.8	2.8	10	4	6	75
GV2R2060690	6	90	2.8	4.2	15	4	6	75
GV2R2080890	8	90	3.8	5.6	20	6	8	75
GV2R2101090	10	90	4.8	7.0	25	6	10	75
GV2R2101290	12	90	5.8	8.4	30	6	12	75

4V2 Tungsten steel cutter slope

HRC52 following
0.5u, Co12%
Plated ALTiN



產品編號	刃徑 d	斜度 α	粗端徑 d1	全長 L	柄徑 D	產品編號	刃徑 d	斜度 α	粗端徑 d1	全長 L	柄徑 D
4V2-040.506	4	0.5°	4.26	50	6	4V2-062.508	6	2.5°	7.75	60	8
4V2-041.006	4	1°	4.52	50	6	4V2-063.010	6	3°	8.1	75	10
4V2-041.506	4	1.5°	4.79	50	6	4V2-065.010	6	5°	9.5	75	10
4V2-042.006	4	2°	5.04	50	6	4V2-067.012	6	7°	10.91	75	12
4V2-042.506	4	2.5°	5.31	50	6	4V2-061012	6	10°	13.05	75	12
4V2-043.006	4	3°	5.57	50	6	4V2-080.510	8	0.5°	8.44	75	10
4V2-045.008	4	5°	6.62	60	8	4V2-081.010	8	1°	8.87	75	10
4V2-047.008	4	7°	7.68	60	8	4V2-081.510	8	1.5°	9.31	75	10
4V2-041008	4	10°	9.3	75	10	4V2-082.010	8	2°	9.74	75	10
4V2-050.506	5	0.5°	5.34	50	6	4V2-082.512	8	2.5°	10.18	75	12
4V2-051.006	5	1°	5.7	50	6	4V2-083.012	8	3°	10.62	75	12
4V2-051.508	5	1.5°	6.04	60	8	4V2-085.016	8	5°	12.37	100	16
4V2-052.008	5	2°	6.39	60	8	4V2-087.016	8	7°	14.14	100	16
4V2-052.508	5	2.5°	6.74	60	8	4V2-0810.16	8	10°	16.82	100	16
4V2-053.008	5	3°	7.1	60	8	4V2-100.516	10	0.5°	10.61	100	16
4V2-055.010	5	5°	8.5	75	10	4V2-101.016	10	1°	11.22	100	16
4V2-057.010	5	7°	9.91	75	10	4V2-101.516	10	1.5°	11.83	100	16
4V2-0510.12	5	10°	12.05	75	12	4V2-102.016	10	2°	12.44	100	16
4V2-060.508	6	0.5°	6.35	60	8	4V2-102.516	10	2.5°	13.06	100	16
4V2-061.008	6	1°	6.7	60	8	4V2-103.016	10	3°	13.67	100	16
4V2-061.508	6	1.5°	7.05	60	8	4V2-105.016	10	5°	16.12	100	16
4V2-062.008	6	2°	7.4	60	8	4V2-107.016	10	7°	18.3	100	16

Tungsten steel chamfering knife

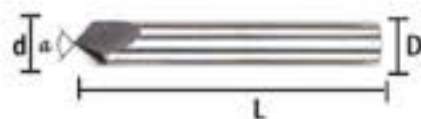

HRC45 following
0.6u, Co12%

產品編號	刃徑 d	角度 α	柄徑 D	全長 L
2R2040490	4	90	4	50
2R2060690	6	90	6	50
2R2080890	8	90	8	60
2R2101090	10	90	10	75

RC Tungsten steel outside the R angle cutter



HRC45 following
0.6u, Co12%

產品編號	外R角/R	先端徑 d1	刃徑 d	柄徑 D	全長 L
RC 0104	0.5R	1.5	2.7	4	50
RC 0154	0.75R	1.5	3.2	4	50
RC 0204	1R	1.5	3.7	4	50
RC 0254	1.25R	1.5	4.2	6	50
RC 0304	1.5R	1.5	4.7	6	50
RC 0354	1.75R	1.5	5.2	6	50
RC 0404	2R	1.5	5.7	6	50
RC 0504	2.5R	1.5	6.7	8	60
RC 0604	3R	1.5	7.7	8	60
RC 0704	3.5R	2	9.2	10	75
RC 0804	4R	2	10.2	12	75
RC 1004	5R	3	13.2	14	100
RC 1204	6R	3	15.2	16	100

V2SD Tungsten steel drilling knife



HRC52 following
0.5u, Co12%
Plated ALTiN

產品編號	刃徑 d	角度 α	刃長 l	柄徑 D	全長 L
V2SD0390	3	90°	8	3	50
V2SD0390L	3	90°	8	3	75
V2SD0490	4	90°	11	4	50
V2SD0490L	4	90°	11	4	75
V2SD0690	6	90°	15	6	50
V2SD0690L	6	90°	15	6	100
V2SD0890	8	90°	20	8	60
V2SD0890L	8	90°	20	8	100
V2SD1090	10	90°	25	10	75
V2SD1090L	10	90°	25	10	100
V2SD1290	12	90°	30	12	75
V2SD1290L	12	90°	30	12	100
V2SD1690	16	90°	45	16	100
V2SD1690L	16	90°	45	16	150

Tungsten steel flat bottom drill bits



HRC45 following
0.5u, Co10%

產品編號	直徑D	刃長l	全長L	柄徑d	產品編號	直徑D	刃長l	全長L	柄徑d
SDEXZ010	1.0	3.3	50	6	SDEXZ060	6.0	3.3	50	6
SDEXZ011	1.1	3.5	50	6	SDEXZ061	6.1	28	60	8
SDEXZ012	1.2	3.9	50	6	SDEXZ062	6.2	28	60	8
SDEXZ013	1.3	4.2	50	6	SDEXZ063	6.3	28	60	8
SDEXZ014	1.4	4.6	50	6	SDEXZ064	6.4	30	60	8
SDEXZ015	1.5	4.9	50	6	SDEXZ065	6.5	30	60	8
SDEXZ016	1.6	5.2	50	6	SDEXZ066	6.6	30	60	8
SDEXZ017	1.7	5.5	50	6	SDEXZ067	6.7	31	60	8
SDEXZ018	1.8	5.8	50	6	SDEXZ068	6.7	31	60	8
SDEXZ019	1.9	6.2	50	6	SDEXZ069	6.9	31	60	8
SDEXZ020	2.0	9	50	6	SDEXZ070	7.0	32	60	8
SDEXZ021	2.1	11	50	6	SDEXZ071	7.1	33	60	8
SDEXZ022	2.2	11	50	6	SDEXZ072	7.2	33	60	8
SDEXZ023	2.3	11	50	6	SDEXZ073	7.3	33	60	8
SDEXZ024	2.4	12	50	6	SDEXZ074	7.4	34	60	8
SDEXZ025	2.5	12	50	6	SDEXZ075	7.5	34	60	8
SDEXZ026	2.6	12	50	6	SDEXZ076	7.6	34	60	8
SDEXZ027	2.7	14	50	6	SDEXZ077	7.7	36	60	8
SDEXZ028	2.8	14	50	6	SDEXZ078	7.8	36	60	8
SDEXZ029	2.9	14	50	6	SDEXZ079	7.9	36	60	8
SDEXZ030	3.0	14	50	6	SDEXZ080	8.0	36	60	10
SDEXZ031	3.1	15	50	6	SDEXZ081	8.1	37	60	10
SDEXZ032	3.2	15	50	6	SDEXZ082	8.2	37	75	10
SDEXZ033	3.3	15	50	6	SDEXZ083	8.3	37	75	10
SDEXZ034	3.4	16	50	6	SDEXZ084	8.4	39	75	10
SDEXZ035	3.5	16	50	6	SDEXZ085	8.5	39	75	10
SDEXZ036	3.6	16	50	6	SDEXZ086	8.6	39	75	10
SDEXZ037	3.7	18	50	6	SDEXZ087	8.7	40	75	10
SDEXZ038	3.8	18	50	6	SDEXZ088	8.8	40	75	10
SDEXZ039	3.9	18	50	6	SDEXZ089	8.9	40	75	10
SDEXZ040	4.0	18	50	6	SDEXZ090	9.0	41	75	10
SDEXZ041	4.1	19	50	6	SDEXZ092	9.2	42	75	10
SDEXZ042	4.2	19	50	6	SDEXZ095	9.5	43	75	10
SDEXZ043	4.3	19	50	6	SDEXZ097	9.7	45	75	10
SDEXZ044	4.4	21	50	6	SDEXZ100	10.0	45	75	10
SDEXZ045	4.5	21	50	6	SDEXZ105	10.5	48	75	10
SDEXZ046	4.6	21	50	6	SDEXZ110	11.0	50	75	10
SDEXZ047	4.7	22	50	6	SDEXZ115	11.5	52	75	10
SDEXZ048	4.8	22	50	6	SDEXZ120	12.0	54	75	10
SDEXZ049	4.9	22	50	6					



PERFECT TECHNOLOGY CO.,LTD

TEL:04-26865253 FAX:04-26882279

E-MAIL: info@perfect-cnc.com

SKYPE: s26865253 LINE: 0912001405

No.169, Dazhi St, Dajia Dist, Taichung City 437, Taiwan (R.O.C)